

EQ MODEL

SPRING BALANCER WITH LOAD INDICATOR



The spring balancer maintains loads in a suspended state. In this way it can be used to keep tools suspended, allowing the operator greater work freedom and reducing their fatigue.

Recommended for repetitive tasks in industrial, automotive and assembly sectors in general.

Its application makes it possible to significantly reduce the intensity of the workload, improve production efficiency and working conditions.

Main features:

- Additional anchor to prevent falls according to DIN-15112 standard.
- Load indicator, allows easy reading of existing load
- Cable guide made of nylon, reduces deterioration of the cable and the housing.
- Nylon cable winder, reduces friction and cable deterioration. *
- Safety device, automatically blocks the cable in case of breakage or load shedding.

Note:

The EQ80100 and EQ100120 models do not have a load indicator.

* Only available for models from EQ1522 to EQ7080

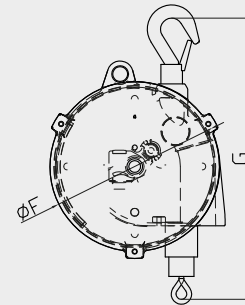
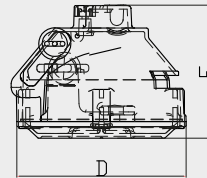
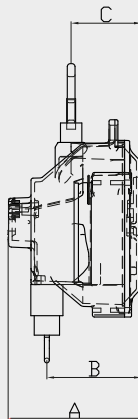

CODE	LOAD CAPACITY (kg)	CABLE LENGTH (m)	HEIGHTS							WEIGHT (kg)
			A	B	C	D	E	F	G	
EQ59	5-9	1,3	136	100	72	160	136	174	355	3,6
EQ915	9-15	1,3	136	100	72	160	136	174	355	4
EQ1522	15-22	1,5	160	115	80	233	160	215	450	7,4
EQ2230	22-30	1,5	160	115	80	233	160	215	450	7,8
EQ3040	30-40	1,5	190	140	105	238	190	215	440	10
EQ4050	40-50	1,5	190	140	105	238	190	215	440	10,6
EQ5060	50-60	1,5	200	150	115	238	200	217	435	11,8
EQ6070	60-70	1,5	200	150	115	238	200	217	435	12
EQ7080	70-80	1,5	200	150	115	238	200	217	435	12,5
EQ80100	80-100	1,5	264	215	173	247	264	215	455	13
EQ100120	100-120	1,5	264	215	173	247	264	215	455	14

RECOMMENDED ACCESSORIES



TYPE A TROLLEY
500 SERIES
Pag. 22



ANCHOR CLAMPS
BC MODEL
Pag. 25



SPINDLE CLAW
WF MODEL
Pag. 49